

Angular Couplings

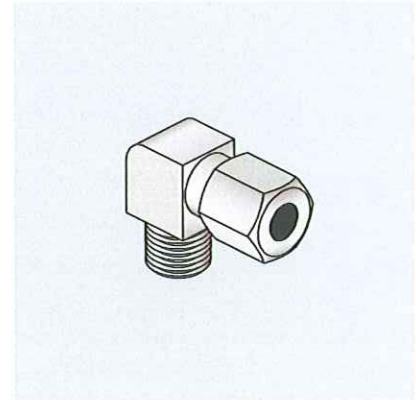
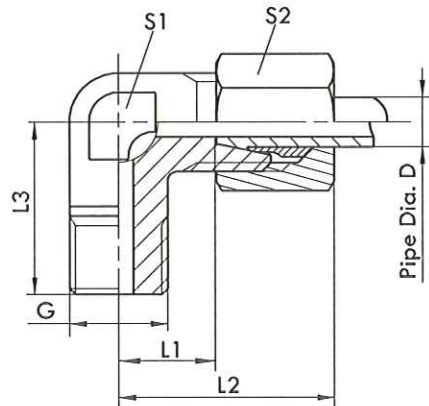

Part-No.	G	L1	Approx. L2	L3	S1	S2	Pipe Dia. D	Material
0401 2210 406	M6k	11	21	17	9	10	4LL	Steel
0401 2210 506	M8x1k	11	21	17	9	10	4LL	Steel
0401 2210 513	M8x1k	11	21	17	9	10	4LL	1.4751
0401 2210 306	M10x1k	11	21	17	11	10	4LL	Steel
0401 2210 613	R1/8"k	11	21	18	11	10	4LL	Steel
0401 2200 406	M6k	9,5	21	17	11	12	6LL	Steel
0401 2200 413	M6k	9,5	21	17	11	12	6LL	1.4305
0401 2200 506	M8x1k	9,5	21	17	11	12	6LL	Steel
0401 2200 513	M8x1k	9,5	21	17	11	12	6LL	1.4305
0401 2200 306	M10x1k	9,5	21	17	11	12	6LL	Steel
0401 2200 313LL	M10x1k	9,5	21	17	11	12	6LL	1.4305
0401 2201 006	M10x1k	12	27	20	12	14	6L	Steel
0401 2220 606	R1/8"k	11,5	23	20	12	14	8LL	Steel
0401 2200 613LL	R1/8"k	10	22	17	11	12	6LL	1.4305
0401 2200 806	R1/4"k	16	31	27	14	17	6S	Steel
0401 2200 813	R1/4"k	16	31	27	14	17	6S	1.4305
0401 2220 306	M10x1k	11,5	23	20	12	14	8LL	Steel
0401 2220 313	M10x1k	11,5	23	20	12	14	8LL	1.4305
0401 2200 606LL	R1/8"k	10	22	17	11	12	6LL	Steel
0401 2220 613	R1/8"k	11,5	23	20	12	14	8LL	1.4305
0401 2220 806	R1/4"k	14	29	27	14	17	8L	Steel
0401 2220 813	R1/4"k	14	29	27	14	17	8L	1.4305

All Parts made of steel are zinc coated and yellow chromated.

Straight Coupling with Conical Thread

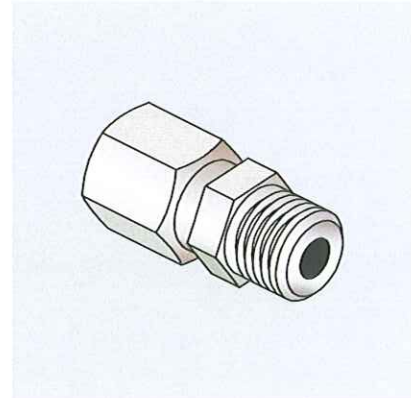
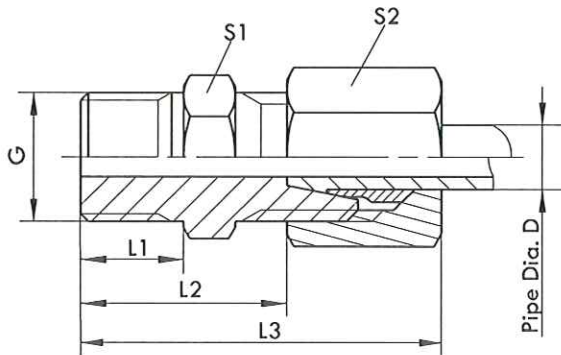

Part-No.	G	L1	L2	Approx. L3	S1	S2	Pipe Dia. D	Material
0401 2010 406	M6k	8	16	26	10	10	4LL	Steel
0401 2010 506	M8x1k	8	16	26	10	10	4LL	Steel
0401 2010 513	M8x1k	8	16	26	10	10	4LL	1.4571
0401 2010 306	M10x1k	8	14,5	26	11	12	4LL	Steel
0401 2010 606	R1/8"k	8	16	26	11	10	4LL	Steel
0401 2000 406	M6k	8	14,5	26	11	12	6LL	Steel
0401 2000 413	M6k	8	14,5	26	11	12	6LL	1.4571
0401 2003 906	M7x1k	8	14,5	26	11	12	6LL	Steel
0401 2000 506	M8x1k	8	14,5	26	11	12	6LL	Steel
0401 2000 513	M8x1k	8	14,5	26	11	12	6LL	1.4571
0401 2000 306	M10x1k	8	14,5	26	11	12	6LL	Steel
0401 2000 313	M10x1k	8	14,5	26	11	12	6LL	1.4305
0401 2000 606	R1/8"k	8	14,5	26	11	12	6LL	Steel
0401 2000 613	R1/8"k	8	14,5	26	11	12	6LL	1.4305
0401 2000 806	R1/4"k	11,5	23,5	40	17	17	6S	Steel
0401 2020 306	M10x1k	8	16,5	28	12	14	8LL	Steel
0401 2020 313	M10x1k	8	16,5	28	12	14	8LL	1.4305
0401 2020 806	R1/4"k	12	20	35	17	17	8L	Steel

All Parts made of steel are zinc coated and yellow chromated.

Straight Couplings with Straight Thread

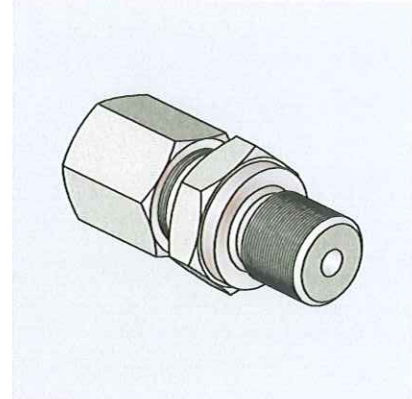
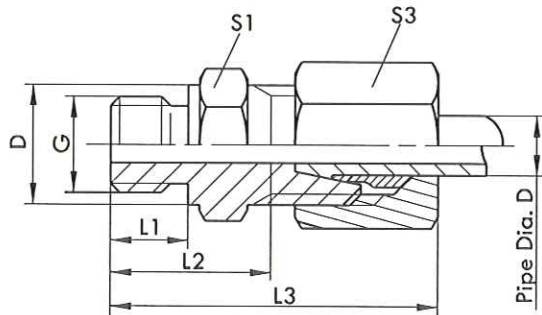

Part-No.	G	L1	L2	Approx. L3	S1	S2	D	Pipe Dia. D	Material
0401 2010 913	G1/8"	8	16	28	14	12	14	4LL	1.4571
0401 2000 206	M10x1	8	16,5	31	14	14	14	6L	Steel
0401 2000 213	M10x1	8	16,5	31	14	14	14	6L	1.4571
0401 2000 906	G1/8"	8	16	28	14	12	14	6LL	Steel
0401 2000 913LL	G1/8"	8	16	28	14	12	14	6LL	1.4571
0401 2001 006L	G1/4"	12	22	37	19	14	18	6L	Steel
0401 2001 006	G1/4"	12	25	40	19	17	18	6S	Steel
0401 2001 013	G1/4"	12	25	40	19	17	18	6S	1.4571
0401 2001 406	G3/8"	12	23,5	38	22	14	22	6L	Steel
0401 2020 213	M10x1	12	22	37	17	17	17	8L	1.4571
0401 2020 906	G1/8"	8	18	29	14	14	14	8LL	Steel
0401 2020 913	G1/8"	8	18	29	14	14	14	8LL	1.4571
0401 2021 006	G1/4"	12	22	37	19	17	18	8L	Steel
0401 2021 013	G1/4"	12	22	37	19	17	18	8L	1.4571
0401 2021 006S	G1/4"	12	27	42	19	19	18	8S	Steel
0401 2021 406	G3/8"	12	23,5	38	22	17	22	8L	Steel
0401 2021 413	G3/8"	12	23,5	38	22	17	22	8L	1.4571

All Parts made of steel are zinc coated and yellow chromated.

Staight Couplings (Pipe Connectors)

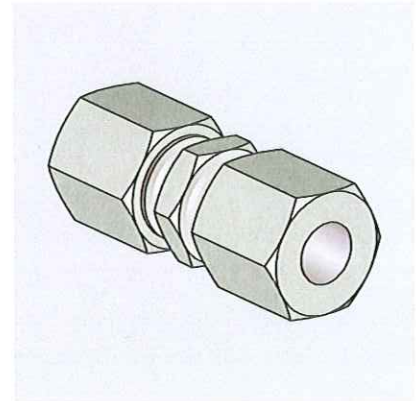
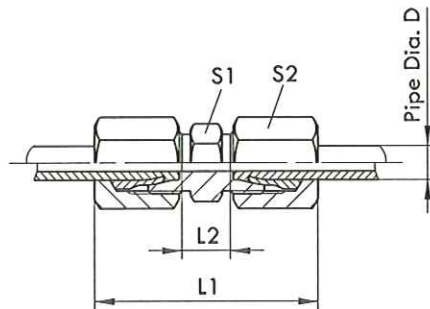

Part-No.	Approx. L1	L2	S1	S2	Pipe Dia. D	Material
0401 3600 106	31	12	9	10	4LL	Steel
0401 3600 306	32	9	11	12	6LL	Steel
0401 3600 313	39	9	11	12	6LL	1.4571
0401 3601 006	39	10	12	14	6L	Steel
0401 3602 006	45	16	14	17	6S	Steel
0401 3600 406	35	12	12	14	8LL	Steel
0401 3601 106	40	11	14	17	8L	Steel
0401 3602 106	47	18	17	19	8S	Steel

All Parts made of steel are zinc coated and yellow chromated.

Banjo Assembly

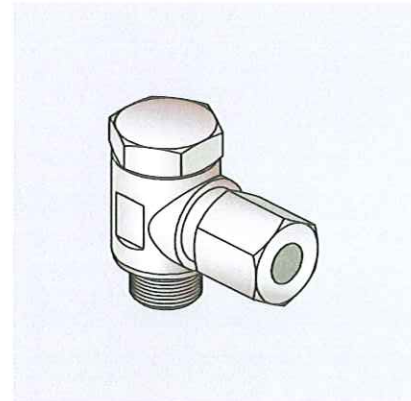
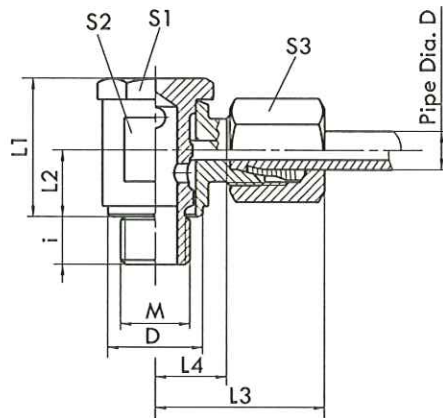

Part-No.	M	L1	L2	Approx. L3	L4	i	S1	S2	S3	D	Pipe Dia. D	Material
0401 3210 206	M10x1	20	9,5	22	10	6	14	14	12	13	4LL	Steel
0401 3210 706	M8x1	18	8	21	11,5	6	14	14	10	13	4LL	Steel
0401 3200 706LL	M8x1	20	9,5	22	10	6	14	14	12	13	6LL	Steel
0401 3200 206LL	M10x1	20	9,5	22	10	6	14	14	12	13	6LL	Steel
0401 3200 206	M10x1	22	10	26	11,5	6	14	17	14	14,5	6L	Steel
0401 3200 906	G1/8	22	10	26	11,5	6	14	17	14	14,5	6L	Steel
0401 3201 006	G1/4	26	12,5	29	14,5	9	19	19	17	18	6S	Steel
0401 3220 206LL	M10x1	21,5	10	23	11	6	14	14	14	13	8LL	Steel
0401 3220 706N	M8x1	21,5	10	23	11	6	14	14	14	13	8LL	Steel
0401 3220 906	G1/8	21,5	10	23	11	6	14	14	14	13	8LL	Steel
0401 3221 006	G1/4	26	12,5	28	13	9	19	19	17	18	8L	Steel

All Parts made of steel are zinc coated and yellow chromated.